

la sécurité
thermique
hautes
performances

high
performance
thermal
safety

Thermal locker for firedoors



Firedoors can be **single or double pedestrian doors**, which are supposed to be always closed, except in evacuation need

...



... or big **underground car park sliding doors**:

These doors are usually left opened, and automatically close (with counterbalance system), in case of fire, to separate parking rooms, and to prevent fire from spreading.

Of course, some pedestrian small doors are available for human safety.

DELTA CONCEPT fabricates and supplies lockers for car park systems, using thermo-bimetal technology, in order to have this function **automatic and energy-autonomous**.

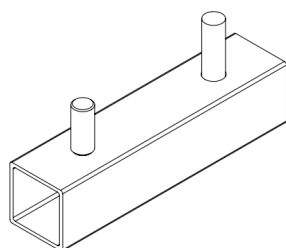
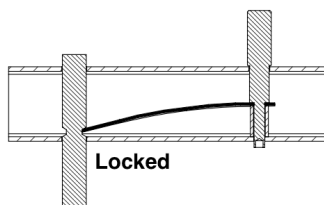
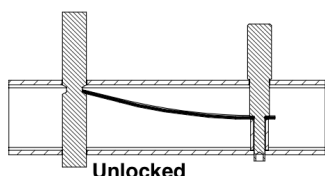

Bimetal technology advantages :

- ✓ Can be used as both thermal-sensor and actuator.
- ✓ Simple and low cost.
- ✓ No need of electric power.
- ✓ Reliable and sustainable.